



## West Airport Palms BUSINESS PARK

- 2355 NW 70th Avenue, Miami, FL 33122
- 2365 NW 70th Avenue, Miami, FL 33122
- 2375 NW 70th Avenue, Miami, FL 33122
- 2385 NW 70th Avenue, Miami, FL 33122

Starting at the low mid

**\$300's**

Limited time only  
Solo por tiempo limitado

- Just steps from Miami Airport
- Units from 1,650 SF - 2,934 SF
- 10% Office area
- Load-bearing mezzanine
- Central air conditioned (Office)
- Street level
- Front loading
- Overhead door (10'W x 12'H)
- Impact resistant windows & doors
- 20' ceiling
- Full sprinkler system
- Twin T concrete roof
- Tri-phase Electrical installation
- CBS block construction

- *A solo pasos del Aeropuerto*
- *Unidades de 1,650 SF - 2,934 SF*
- *Mezantina de almacenaje*
- *10% Area de oficina*
- *Aire acondicionado central (Oficina)*
- *Nivel Planta bajo*
- *Almacén con puerta frontal*
- *Puerta de almacén (10'H x 12'V)*
- *Ventanas y puertas contra huracanes*
- *Altura del techo 20 Pie*
- *Aspersores de agua contra incendio*
- *Techos de concreto estilo "T"*
- *Instalación eléctrica trifásica*
- *Construcción con bloques de concreto*

## West Airport Palms BUSINESS PARK

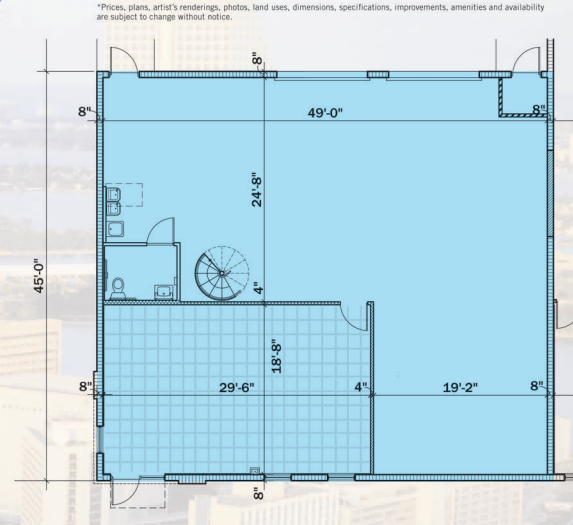
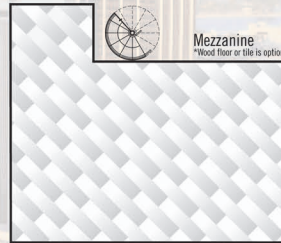

Bay Type "E"

**1/8"**  
Building "B"

1,650 Sq. Ft. Warehouse  
600 Sq. Ft. Office  
600 Sq. Ft. Mezzanine  
3,250 Total Sq. Ft.